

OV1024 | Part No. 122524



OV1024

HEIGHT ADJUSTABLE TABLE

USER GUIDE

OV1024

HEIGHT ADJUSTABLE TABLE

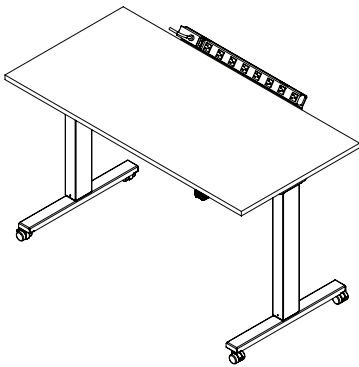

FEATURES

- Complete height adjustable table
- Easy-order with one part number
- Lift capacity up to 150 lb.

TABLE OF CONTENTS

| | |
|------------------------------|------|
| Parts Diagram | 4 |
| Safety Information | 5-6 |
| Assembly Instructions | 7-10 |
| Operation | 11 |
| Troubleshooting | 12 |
| Technical Data | 13 |
| Warranty | 14 |

This manual explains how this sit-stand desk is assembled, used, and maintained. All sit-stand tables are subjected to functional and quality tests before leaving our facility.

OV1024

PARTS DIAGRAM

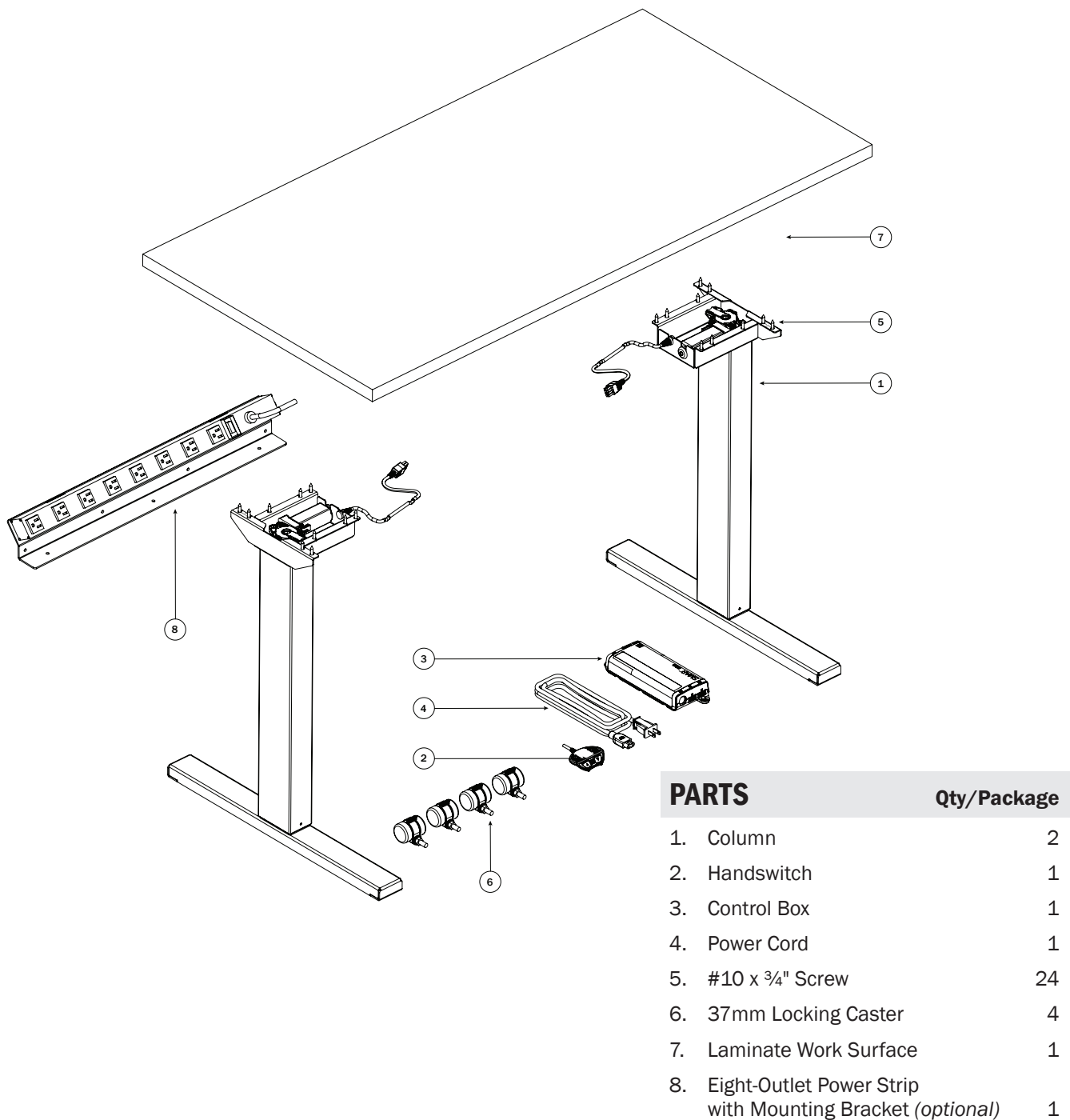

SAFETY INFORMATION

IMPORTANT SAFETY INSTRUCTIONS *Save these instructions.*

DANGER To reduce the risk of electric shock:

Always unplug this furnishing from the electrical outlet before cleaning.

WARNING: To reduce the risk of death, serious injury, or property damage, read and follow this safety information and the provided instructions when assembling this product. Do not change or replace components and accessories provided by OMT-Veyhl.

KEEP AWAY FROM CHILDREN

For indoor use only. Keep small children away from moving desk.

BE CAREFUL WHEN ADJUSTING DESK HEIGHT

Body parts and property can be caught between the moving work surface and an immobile obstacle (such as shelves, furniture, window sills, or walls). Keep at least one inch of clearance around desk and make sure nothing is in table's path for its entire range of motion.

Before raising or lowering:

- Check surroundings on all sides of desk are clear
- Make sure that casters are locked before adjusting desk height
- Make sure corded objects will not be pulled off table or cause other objects to fall
- Make sure desk power cord moves freely as desk moves up and down

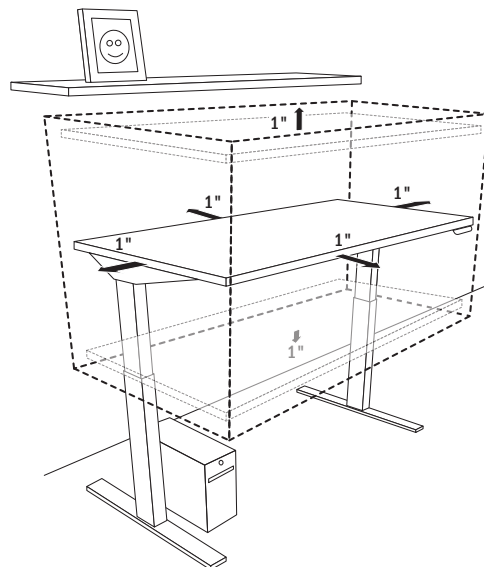

DO NOT OVERLOAD DESK

To prevent table from tipping or collapsing, make sure the desk frame is not overloaded by the weight of tabletop and objects on table. Evenly distribute load; excess loads near edges can reduce stability and lead to tip over.

- Do not exceed maximum load (including weight of desktop) of 150 lb. (68Kg)
- Do not exceed edge load of 25 lb. when positioning monitors or mounting accessories.
- Do not sit or stand on table

USE CARE WHEN MOVING DESK

- Clear objects and equipment from table before moving to reduce the risk of tipping over.
- Adjust the desk to its lowest height before moving
- To disconnect, remove plug from outlet
- Do not move a loaded desk
- Make sure casters are unlocked before attempting to move table

DO NOT OPEN ELECTRICAL COMPONENTS

Do not attempt to service table components. There are no user-serviceable parts inside the motor control units or table legs. If your table needs service, contact customer service. Never operate this table if it has a damaged cord or plug, if it is not working properly, or if it has been dropped or damaged.

KEEP TABLE FRAME DRY

Keep all electrical components away from water and high humidity. Clean only with a dry or slightly damp cloth. Do not spray cleaning solutions directly onto table system.

GROUNDING INSTRUCTIONS

This product is equipped with a cord having an equipment-grounding conductor and a grounding plug. **Use only the cord provided.** Make sure that the product is connected to an outlet having the same configuration as the plug (as shown in Illustration A) that is properly installed and grounded in accordance with all local codes and ordinances.

Do not modify the plug provided with the product – if it will not fit the outlet, have a proper outlet installed by a qualified electrician.

No adapters are to be used with this product.
Keep cord away from heated surfaces.

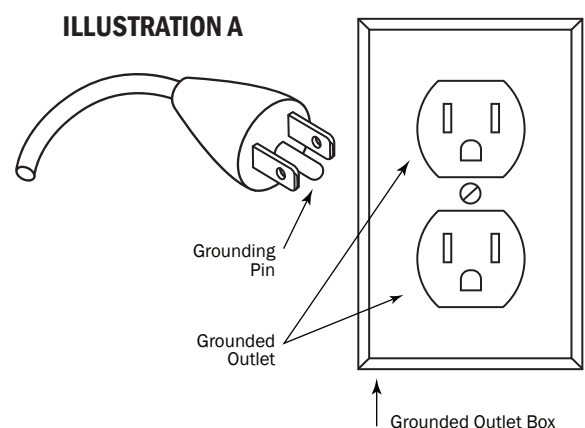

ASSEMBLY INSTRUCTIONS

The assembly of the table frame to be made in accordance with this manual.
Changes to the table frame or improper use may affect the safety, function, and life of your product.

This manual is for all sit-stand tables from the OV1024 series.

ASSEMBLY OVERVIEW

1. Assemble the columns to the work surface
2. Assemble the casters to the feet
3. Fasten the control box and handswitch to the table top
4. Connect the motor cables to the control box
5. Connect the handswitch (HS) cable to the control box
6. Connect the supplied power cord (AC) to the control box
7. Attach all cables to the table frame or on the underside of the table top
8. Assemble power strip (*optional*)

If you have any difficulty assembling this unit, or need to order replacement parts, please contact our Customer Service department. Use the parts diagram on page 4 as a reference.

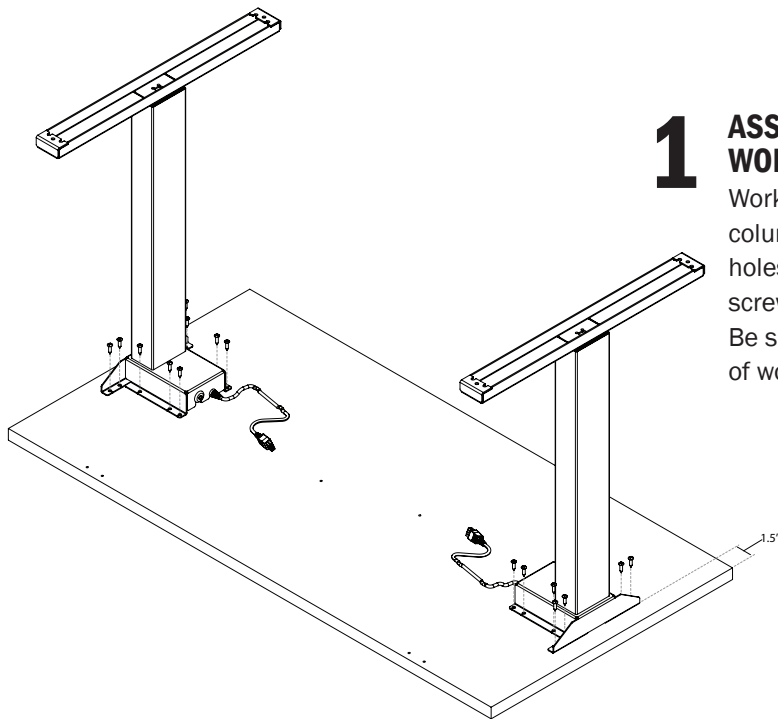

1 ASSEMBLE THE COLUMNS TO THE WORK SURFACE

Work surface is pre-drilled with mounting holes for columns. Align columns with pre-drilled mounting holes in work surface, and use the #10 x $\frac{3}{4}$ " screws to fasten the top support onto the table top. Be sure motor boxes are mounted 1.5" from edge of work surface.

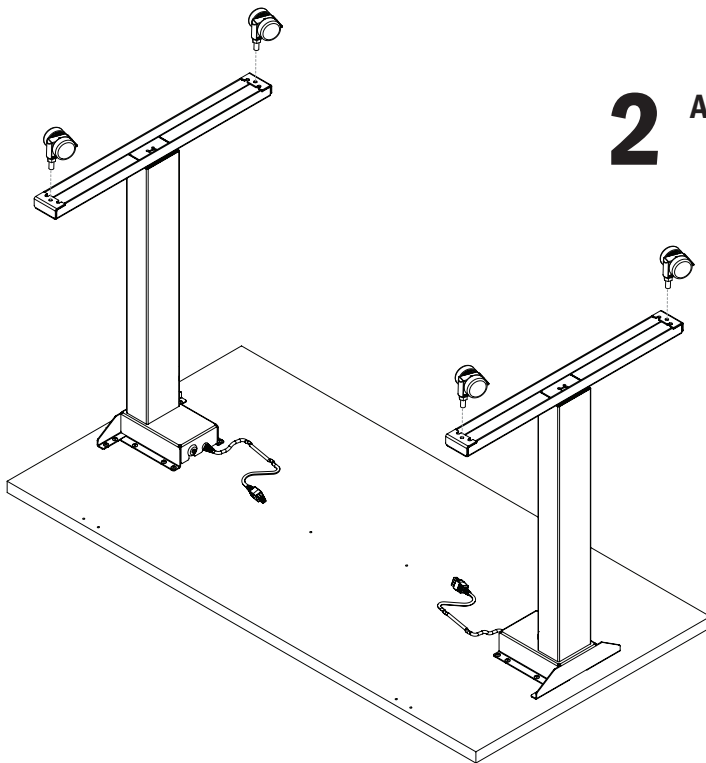

2 ASSEMBLE CASTERS TO THE FEET

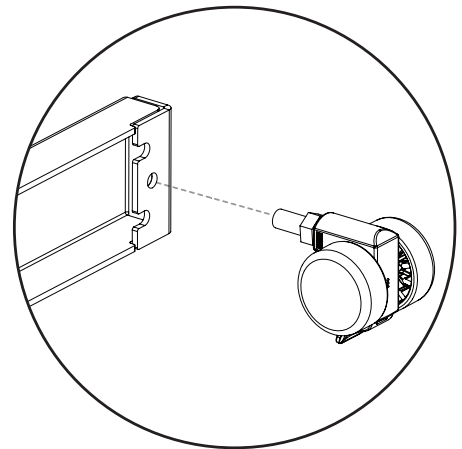

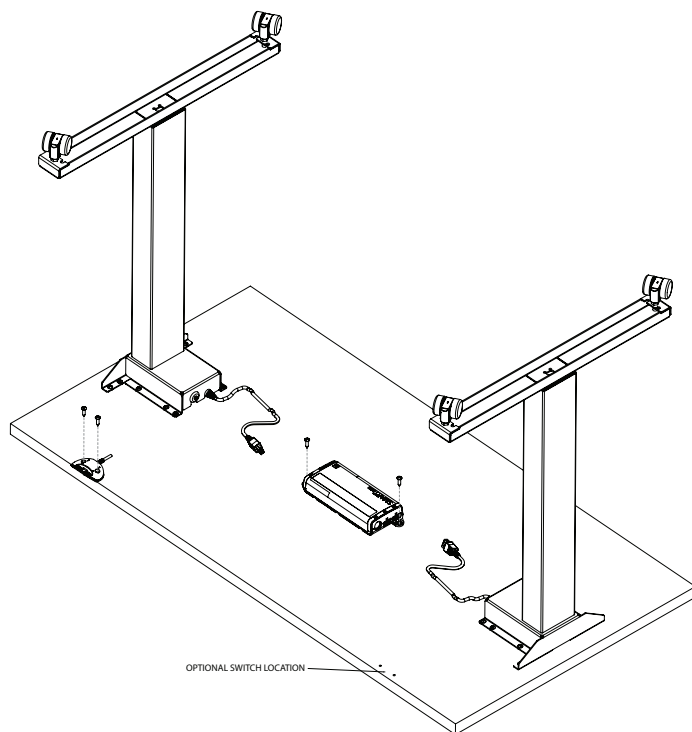

3 FASTEN THE CONTROL BOX AND HANDSWITCH TO THE TABLE TOP

Work surface is pre-drilled with mounting holes for control box and handswitch. Align control box and hand switch with pre-drilled mounting holes in work surface. Make sure the control box and handswitch are fastened so that all the cables will connect without being in tension.

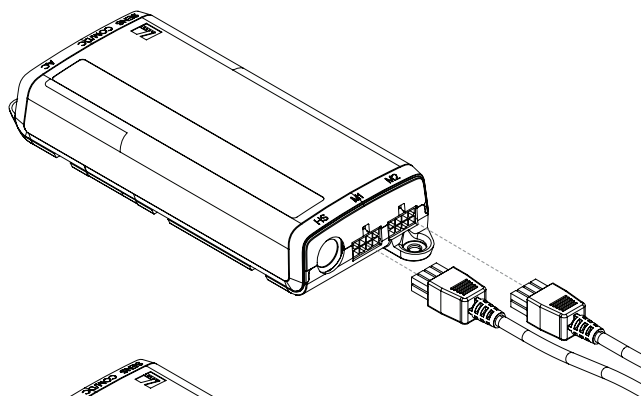

4 CONNECT THE MOTOR CABLES TO THE CONTROL BOX

The motor cable plug-connection has to click into place.

Connections to the control box:
 M1-M2 = Connectors for the columns
 HS = Connectors for the handset
 AC = Connector for the power cord (3-pin)

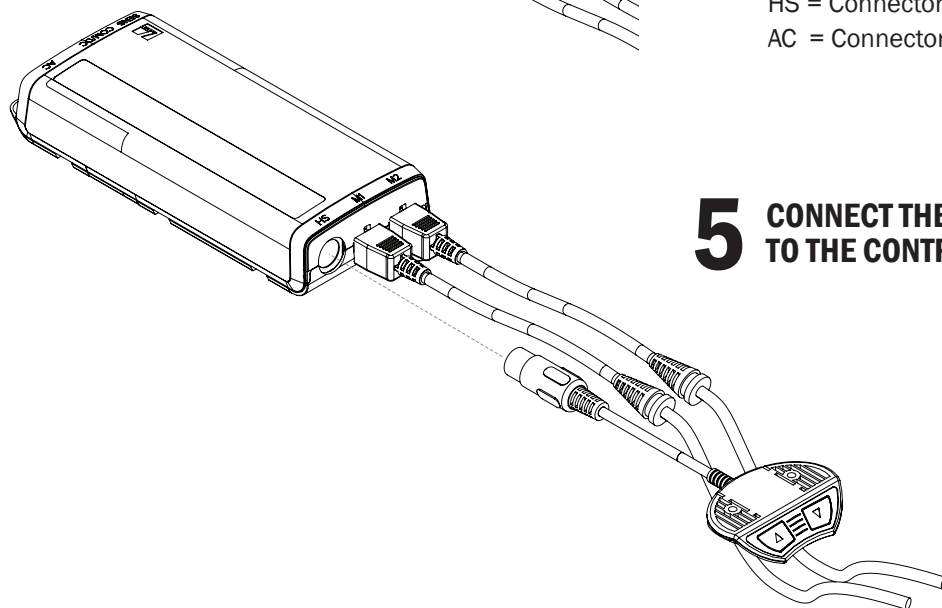

5 CONNECT THE HANDSWITCH (HS) CABLE TO THE CONTROL BOX

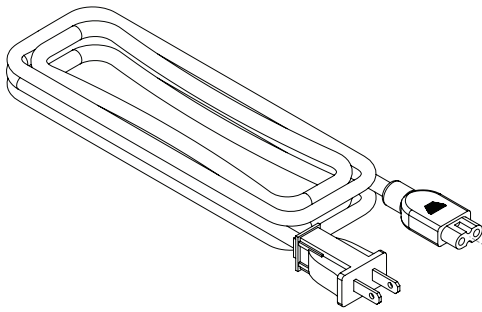

6 CONNECT THE SUPPLIED POWER CORD (AC) TO THE CONTROL BOX

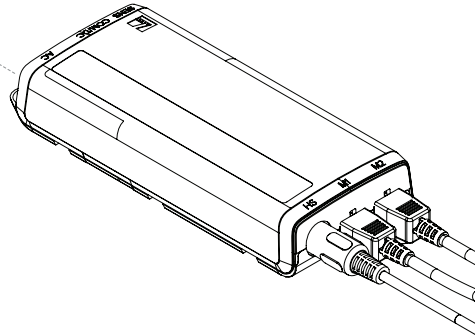

7 ATTACH ALL CABLES TO THE TABLE FRAME OR ON THE UNDERSIDE OF THE TABLE TOP

Attach cables in order to avoid any damage during operation.
Never wrap cables and/or cords around the columns.

8 (OPTIONAL) ASSEMBLE OUTLET POWER STRIP

a Using the provided hardware, fasten the mounting clip to the bracket using 10-32 machine screw and washer. Attach the power strip to the mounting clips.

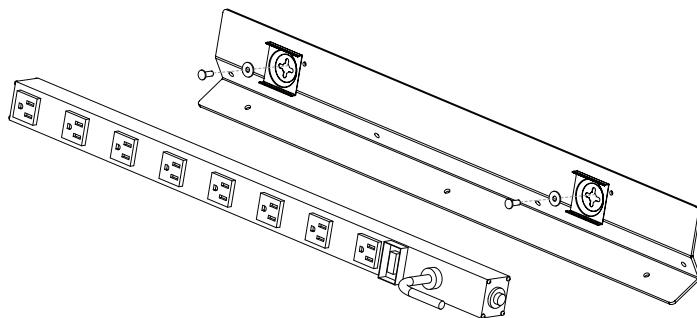

b Using the #10 x 3/4 Screws, attach the power strip assembly to back edge and underside of the table surface.

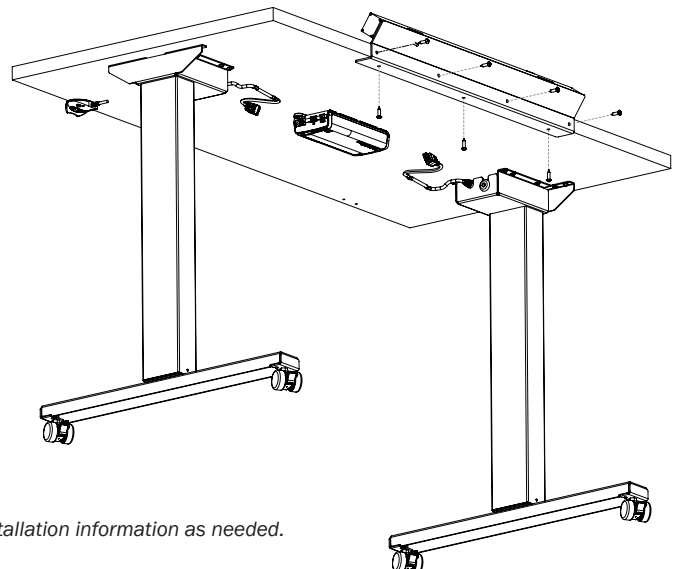

Please reference the power strip's instruction guide for additional installation information as needed.

OPERATION INFORMATION

INITIALIZATION/RESET

The desk must be initialized/reset after any of the following:

- After assembly
- After disconnection from the power supply
- After any impact on the table top.

To initialize/reset, move the table to the lowest position by pressing the DOWN button on the handswitch until the columns reach the lowest position. Press the DOWN button again until the table moves slightly down to the machine zero point and back up to the operation zero point. Release the DOWN button. If the button is released too soon, the table legs will not move up. Repeat the reset process.

The control box is programmed with a parameter file which controls the table legs' lower and upper travel limits. **Under no circumstance should a control box from one table be moved to another.**

NORMAL HANDSWITCH OPERATION (for all handswitch types)

By pressing the UP or DOWN buttons, the table will move up or down to the desired position. Once the desired position is reached, let go of the UP or DOWN button. The table legs will stop once they reach the lower or upper height limits.

TROUBLESHOOTING

UNIT

| ERROR CODE | SOURCE | SOLUTION |
|--|---|---|
| Table does not move | No power supply | Plug in the power cord or check the connection on the control box |
| | No connection or a loose connection to the drives | Verify the plug connections of the motor cable to the control box |
| | No connection or a loose connection to the handswitch | Verify the plug connections of the motor cable to the control box |
| | Max lifting capacity is exceeded | Reduce the weight or load on the desktop |
| | Max time limit is exceeded | Control is activated automatically after approx. 9 minutes |
| | Defective drive | Contact customer service |
| | Defective control box | Contact customer service |
| | Defective handswitch | Replace the handswitch |
| Table moves down at a slow rate | Control box expects new reset | Reset control box. (See page 11) |
| During operation, tables moves at a slow rate | Max lifting capacity is exceeded | Reduce weight |
| Table moves on one side only briefly and then stops | No connection or a loose connection to the drives | Verify the plug connections of the motor cable to the control box and reset the control box |
| | Defective drive | Contact customer service |

If it is not possible to resolve an error as described, disconnect the power cord, wait a few minutes and reset the table again. If the error still occurs, remove the table from the power source and contact customer service. *(Error Code list is valid from firmware 1.7.5 and higher)*

TECHNICAL DATA

| GENERAL CONTROL BOX | |
|---|----------------------------------|
| Power supply | 120 VAC \pm 10% / 60 Hz |
| Standby power consumption, primarily | <0.3 W |
| Operating temperature | 0-35 °C |
| Protection class | IP 20 |
| Maximum power output | 240VA/24V |
| TWO-COLUMN FRAME WITH CONTROL BOX | |
| Maximum lift capacity | 150 lb (\approx 68 kg / 667N) |
| Adj. range, depending on version | View Illustration B |
| Maximum input current | 5 A |
| Maximum duty cycle | 30 sec. on / 9 min. off |

ILLUSTRATION B

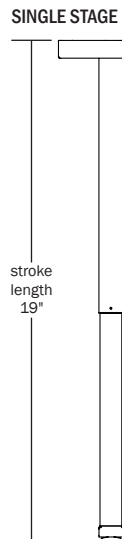

WARRANTY

CONTACT YOUR SALES REPRESENTATIVE FOR WARRANTY INFORMATION



End of life cycle: Once product is disassembled, all steel components can be recycled at your local metal collector.

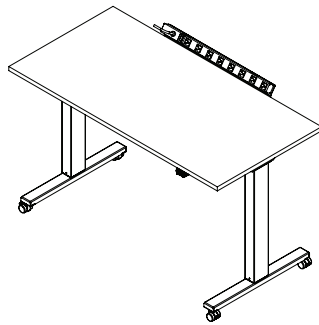

OV1024 USER GUIDE

Part No. 122524